

**DESCRIPTION**

The **GEFCO Select #SE143-Series Fan Jet** will produce a flat sheet of flowing water. This effect makes an aesthetic statement in both a daytime operation or at night when used in combination with any type of underwater illumination by Georgia Fountain Company. The Fan Jet must be fed with a non-turbulent water supply for a solid sheet of water.

The GEFCO Select #SE143-Series Fan Jet is constructed of cast bronze stainless steel fitted. The jet is also provided with female N.P.T. connection.

A GEFCO Select #SE137-Series Adjustment Flange is designed to correct the vertical adjustment of spray up to 5° off of vertical, for larger adjustment use a GEFCO Select #SE138-Series Swivel Union (both #SE137-Series and #SE138-Series can be ordered separately).

The GEFCO Select #SE143-Series Fan Jet can be installed on a GEFCO #PE109-Series Slab Penetration which will provide a rigid, non-corrosive water proofing penetration.

When specifying use suffix:

- 1 for 90° spray pattern
- 3 for 170° spray pattern
- 15 \*1.5" NPT 90°
- 16 \*2" NPT 90°
- 30 \*2" NPT 170°

**TYPICAL SPECIFICATIONS:**

\* **GEFCO Select #SE143-XX** Fan Jet:

- made of machined cast bronze and SST fitted.
- XX° spray angle (specify 90° or 170°).

**ADDITIONAL INFORMATION:**

- Suction Straining required to be: **MAX. 0.125"**.
- For vertical performances convert H1 into SH and reduce 50 % approximately, increase H2 200 % approximately.

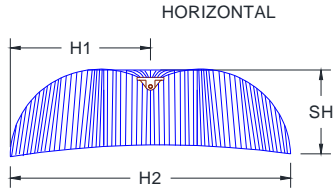
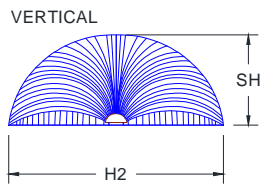

**IMPORTANT REQUIREMENT**

Designers and Engineers shall be responsible for the accuracy of system flow rates and especially system head loss requirements. Stated flows and head pressure requirements for any listed spray height are required AT THE NOZZLE. Extrapolations for unlisted spray heights are at the sole responsibility of the Designers and/or Engineers.

**IMPORTANT**

Dimensions, Manufacturers and/or Materials subject to change without notice

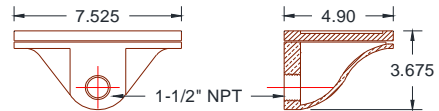

90° SHEET OF WATER JET.

DIMENSIONS:(in inches)

T	1.5
T	2

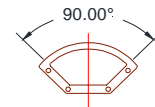

H1 INCHES	H2 INCHES	GPM	Ft. HEAD
12"	21"	19	3
24"	27"	33	6
36"	49"	45	9
48"	59"	55	13
60"	70"	65	16
72"	82"	75	19

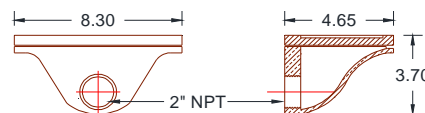
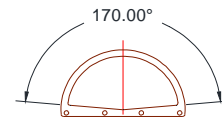

170° SHEET OF WATER JET

H1 INCHES	H2 INCHES	GPM	Ft. HEAD
12"	35"	37	3
24"	55"	66	6
36"	79"	98	9
48"	99"	117	13
60"	120"	138	16
72"	150"	159	19