

DESCRIPTION

The **GEFCO #PE108C-XX ANTI VORTEX PLATE** provides dispersion of discharged water for water falls or bowls. This unit is available in various sizes: 12", 16", 18" or 24". This unit is provided with a 3/8" x 3/8" SST perimeter frame for tile set mounting and is equipped with 3/8" mounting holes.

The unit is typically mounted following pool floor finishes complete. For preformed suction of discharge sumps specify **GEFCO #PE108 Series ABS** molded plastic sumps.

When specifying, please use the following suffix to ensure the proper version is provided:

GEFCO #PE108C-XX
XX = 12", 18" or 24"

TYPICAL SPECIFICATIONS:

- * **GEFCO #PE108C-XX ANTI VORTEX PLATE:**
- XX" SST Surface Mount Frame (specify size).
- 4 ea. 3/8" mounting holes.
- #18 Gauge SST, press boko on diagonal axis
- with 3/8" perimeter tile set lip recess

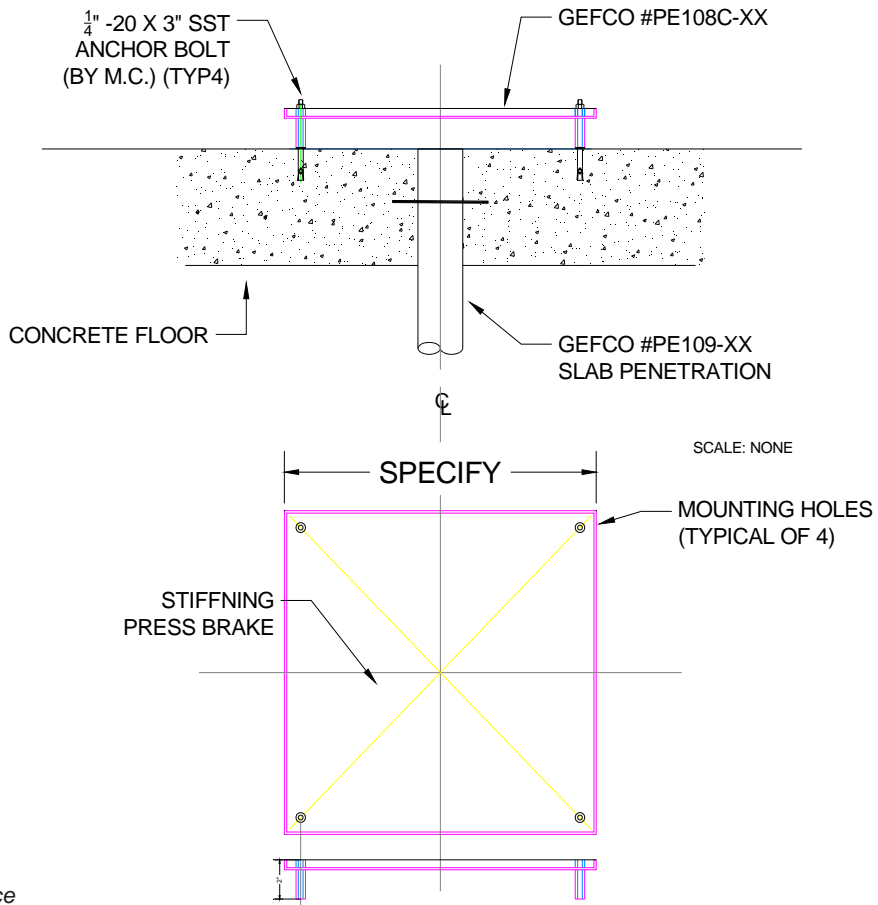

IMPORTANT
Dimensions and/or Materials
subject to change without notice